

Note: The external wall form can choose masonry structure or wooden structure, which is determined by the user according to the needs. Doorway style for reference.

PYRAPOD 4T-2

Roof Panel

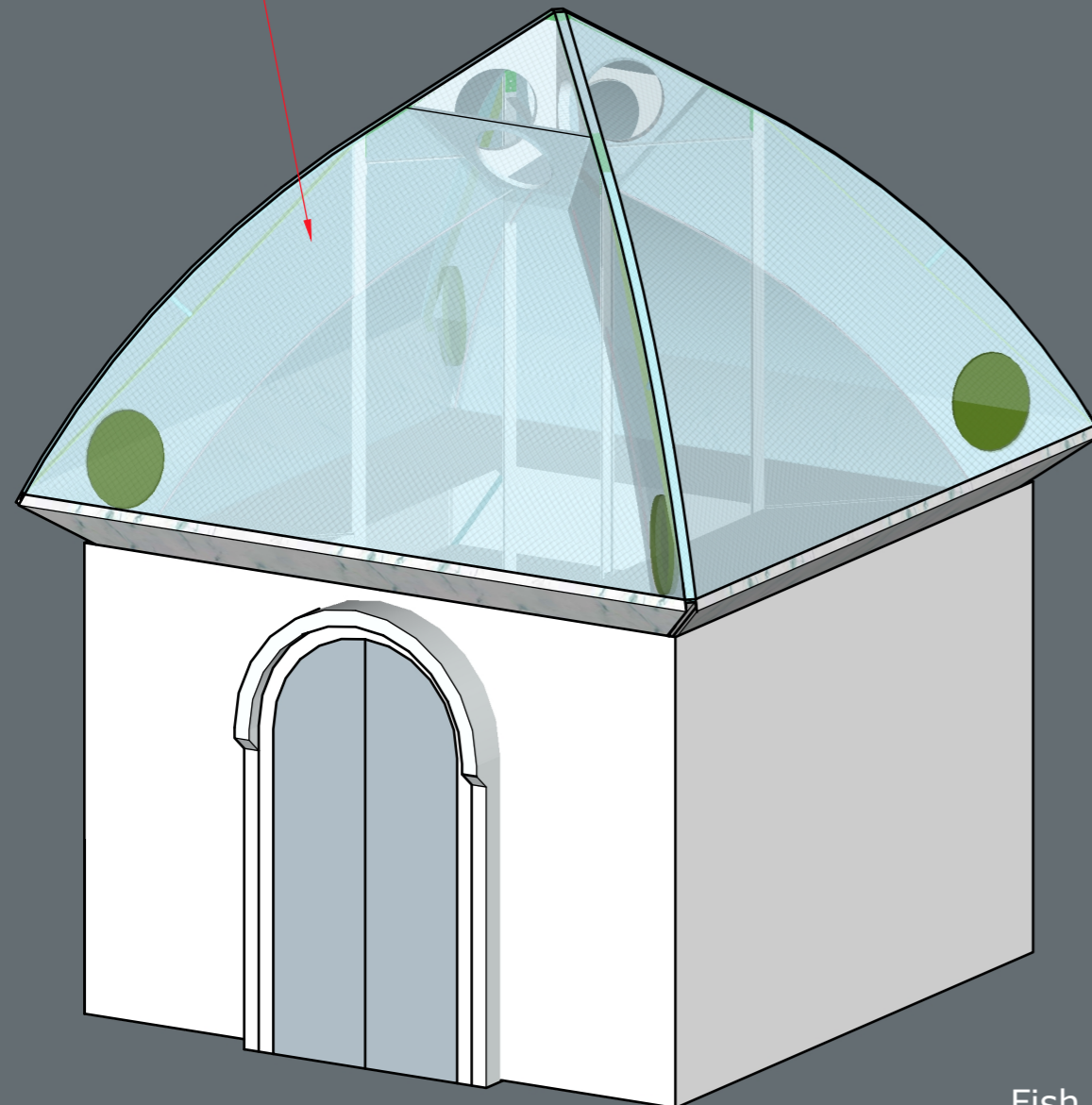

Bubble Machine

Planting shelf

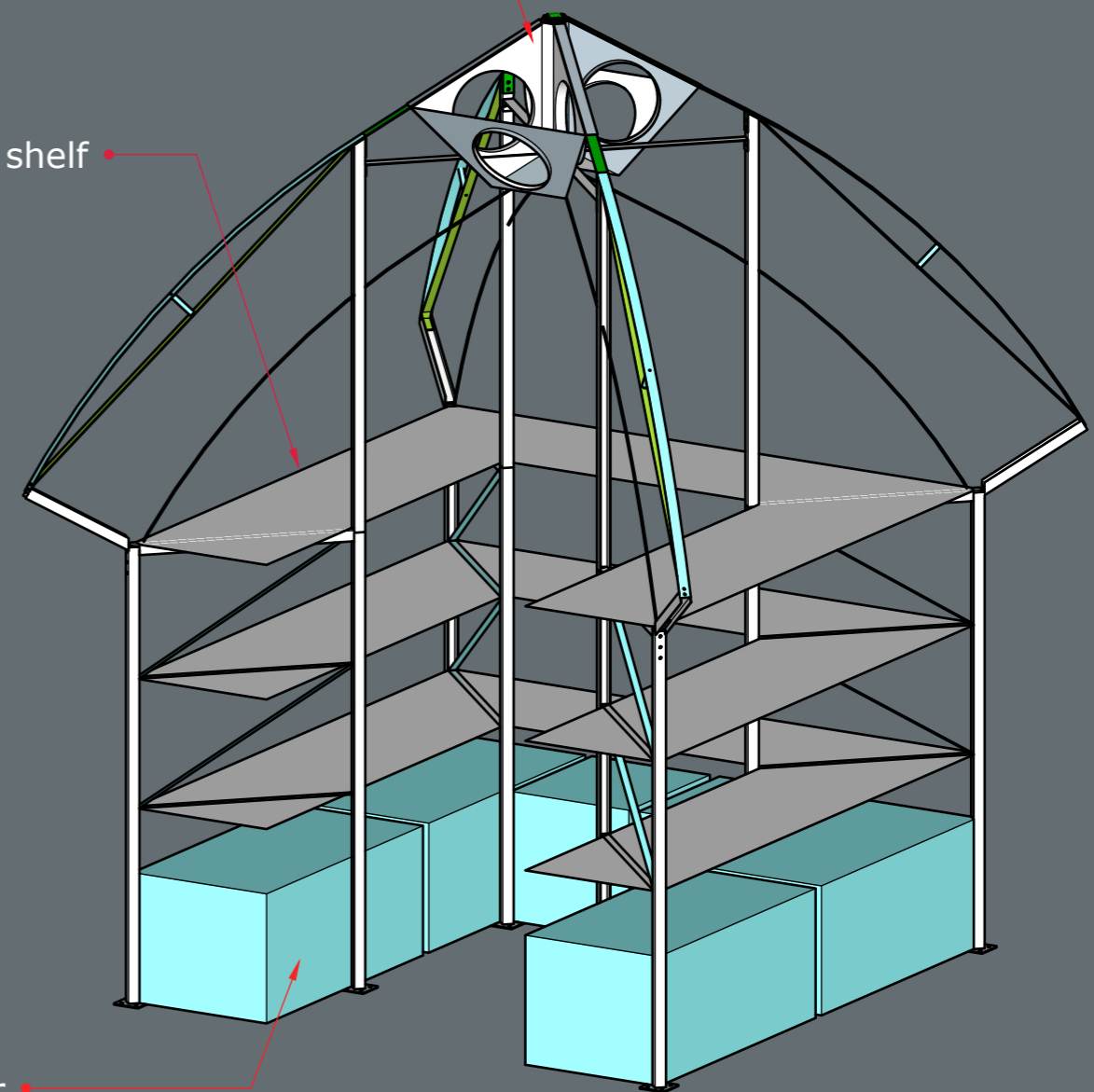

Fish tank and reservoir

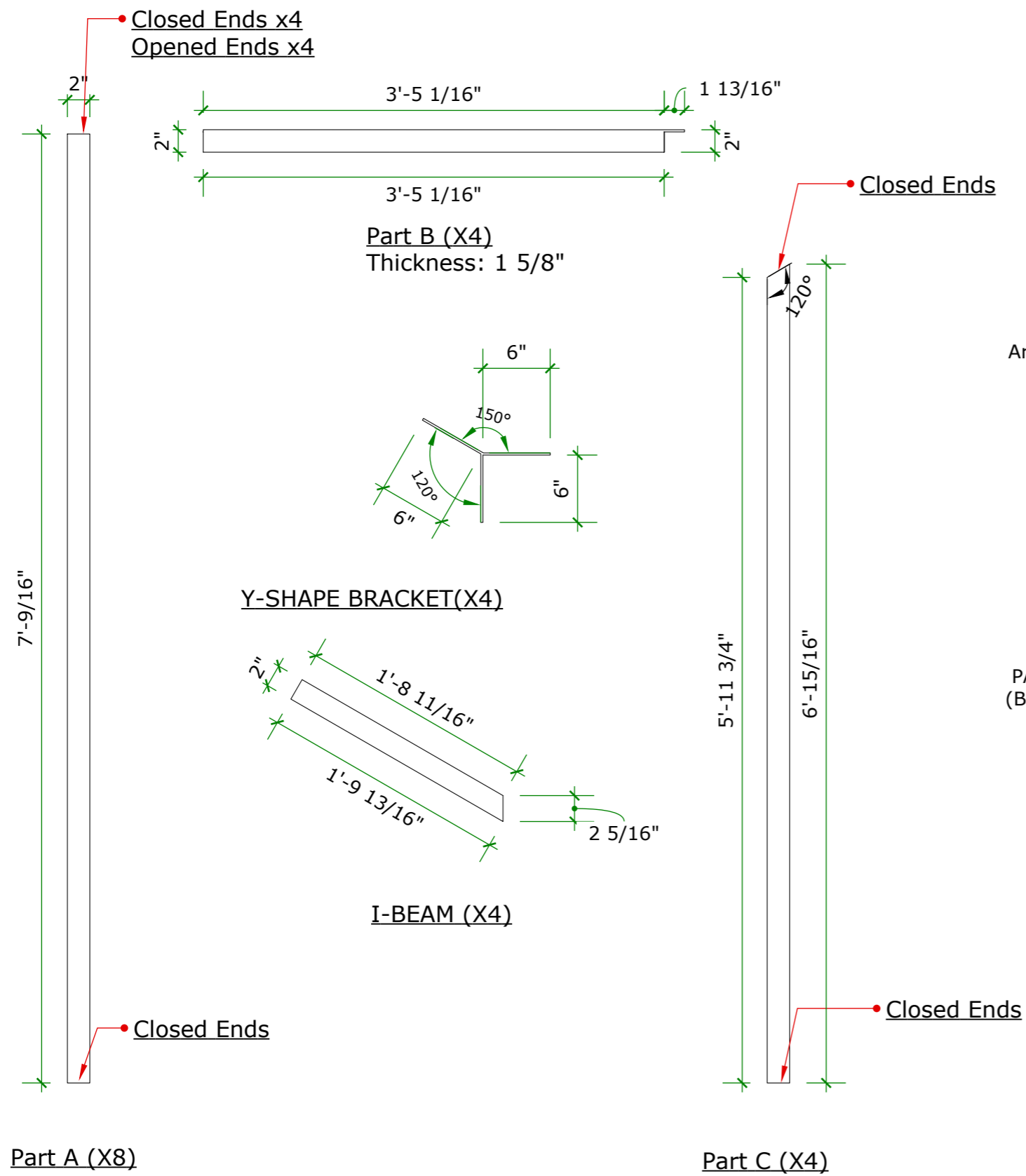

I-BEAM & U-Shape Column Elevation

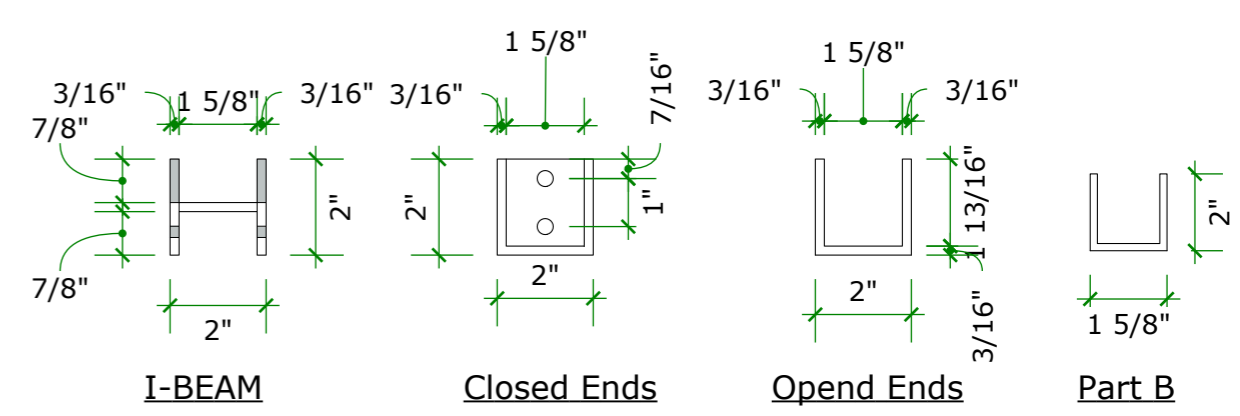
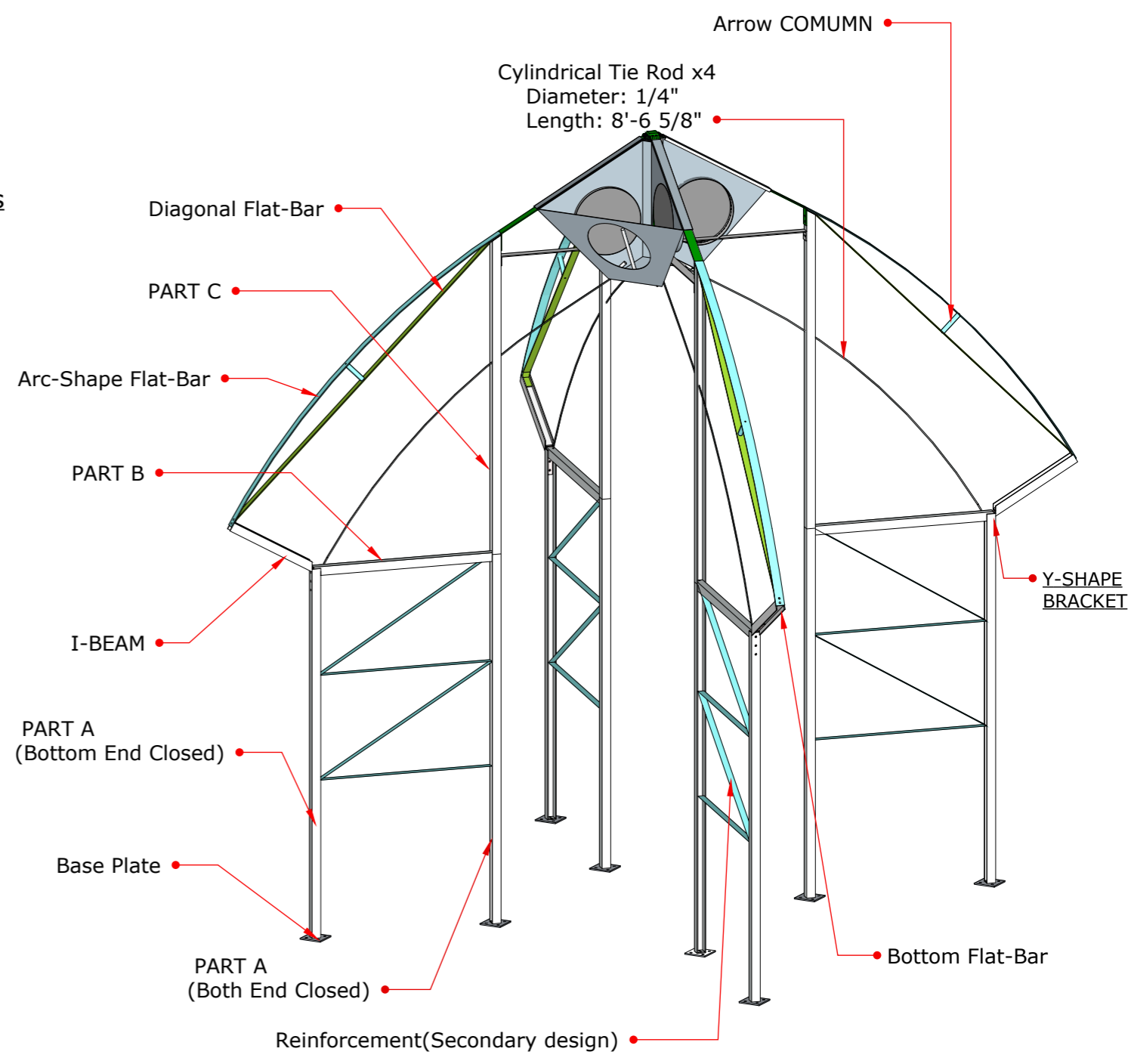

I-BEAM & U-Shape Column Section

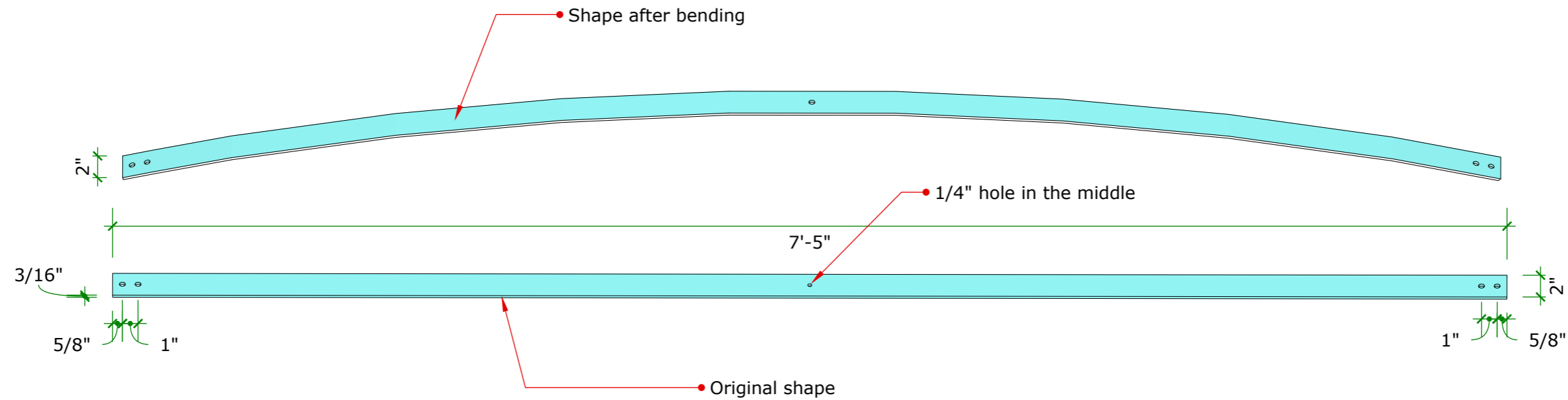

Arc-Shape Flat-Bar(x4)

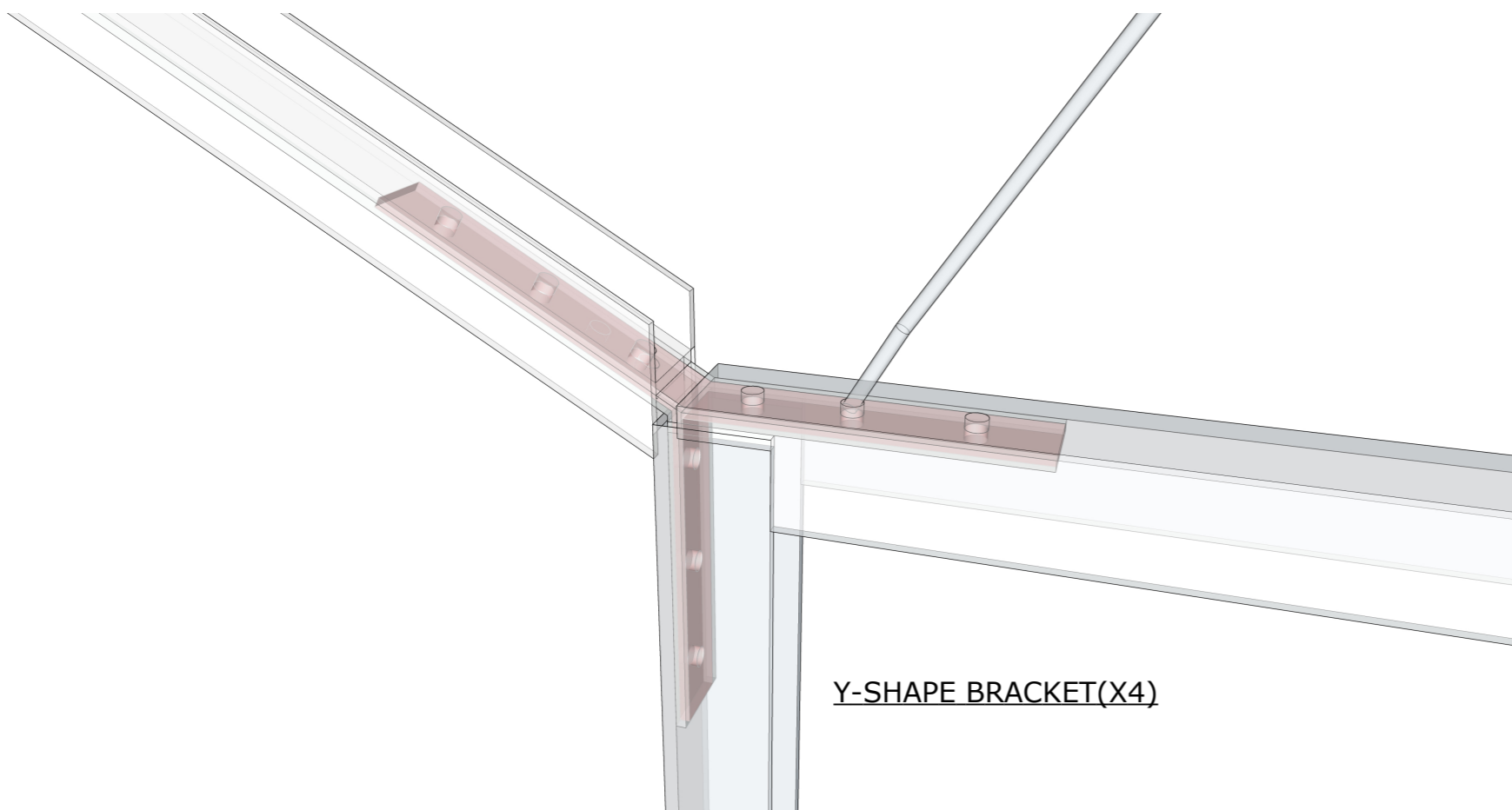

Y-SHAPE BRACKET(X4)

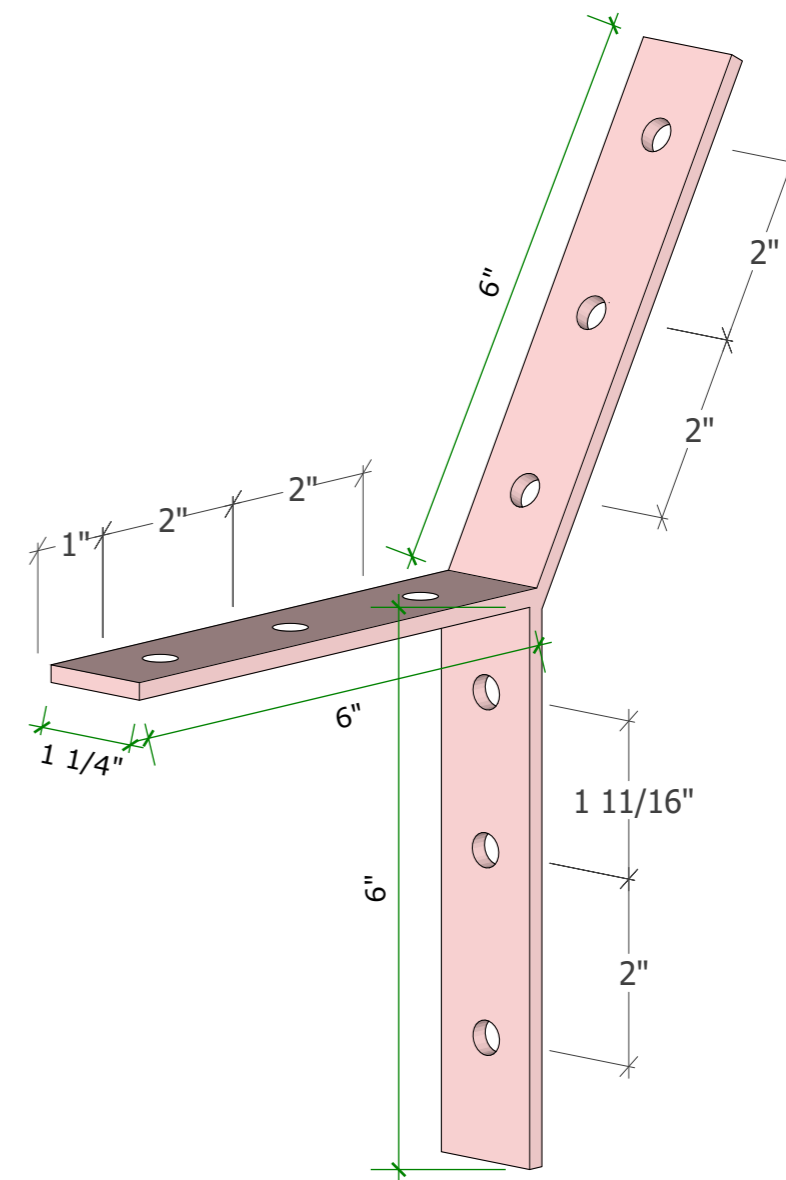

Y-SHAPE BRACKET(X4)

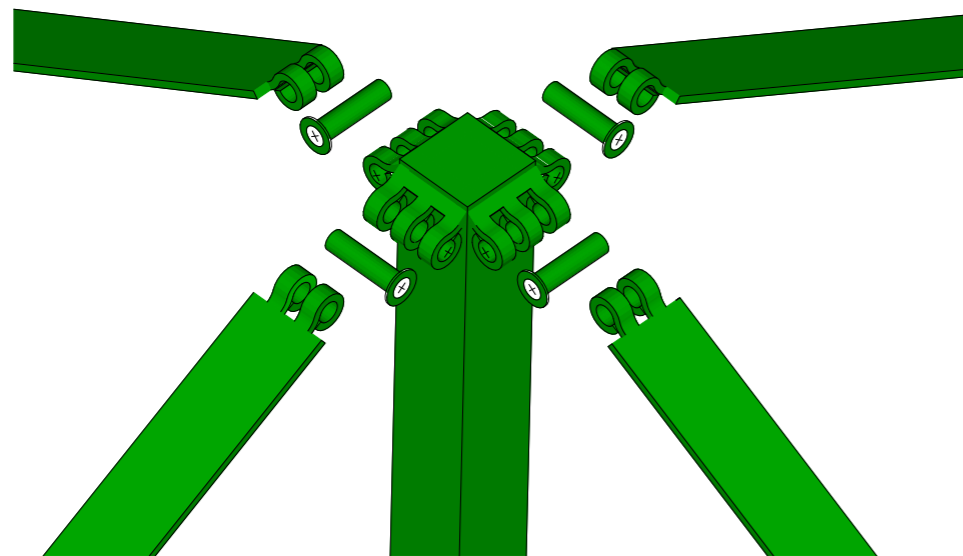

FOUR-SIDE HINDGE

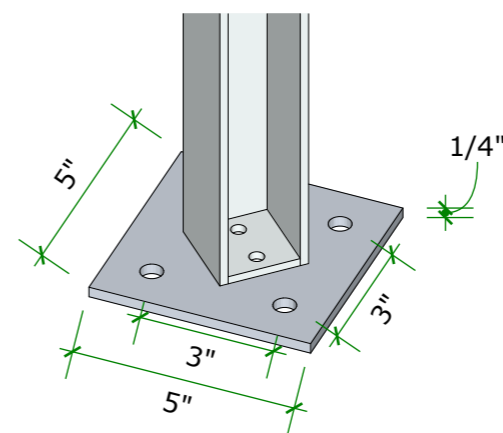

Base Plate (x8)

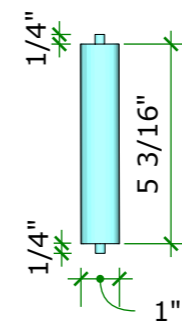

Arrow Column (x4)

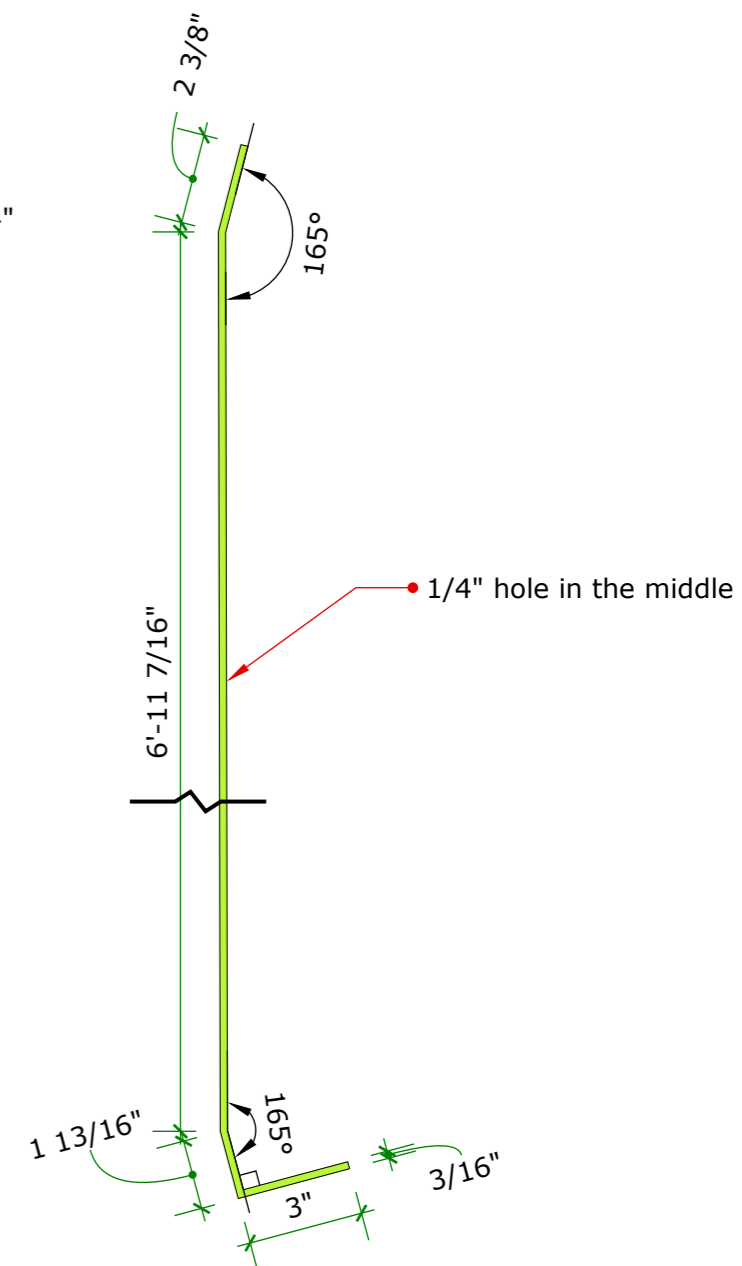

Diagonal Flat-Bar (x4)

Total Length: 7' 6 9/16"
 Thickness: 3/16"
 Width: 2"

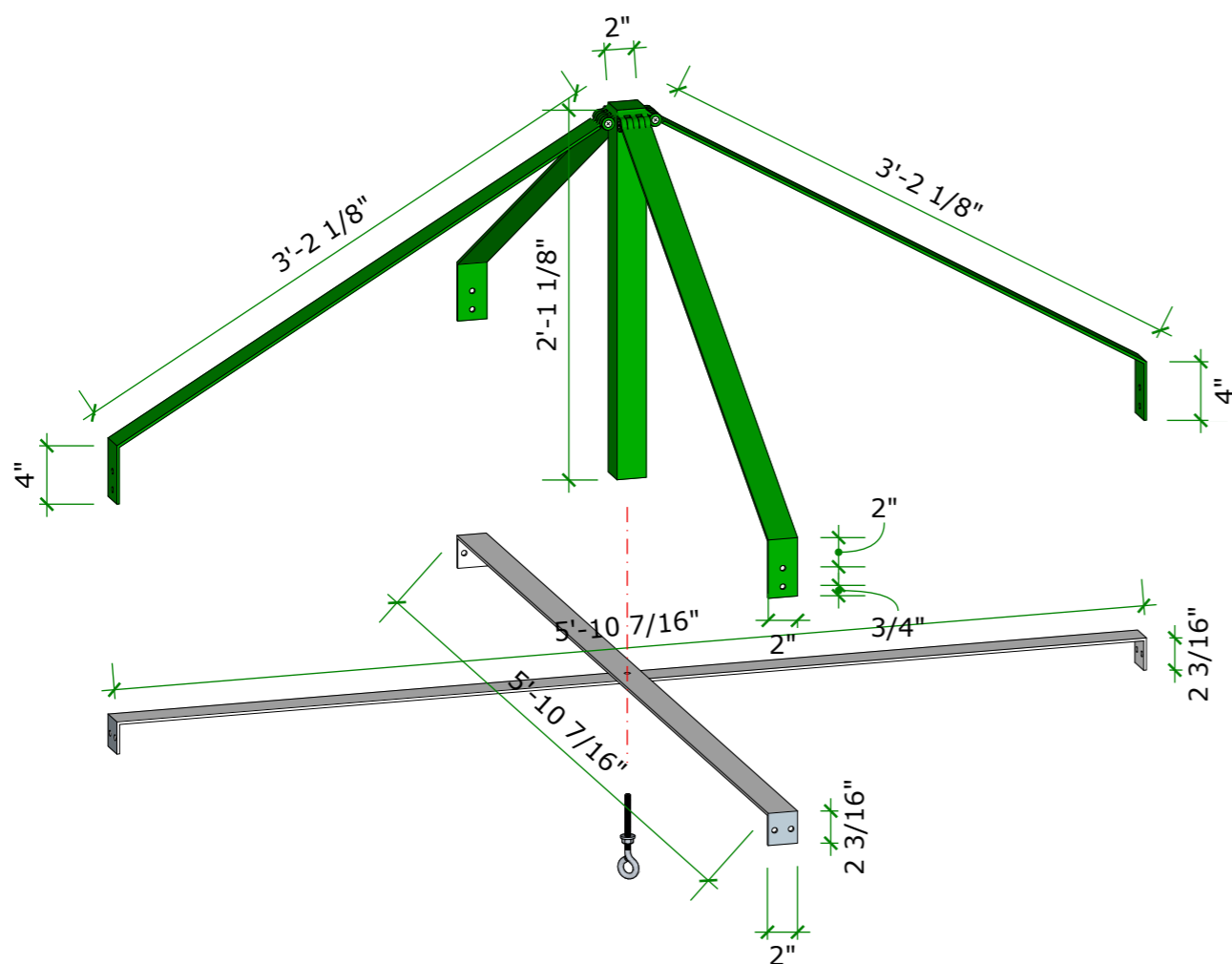

PYRAMID FRAME (UMBRELLA)

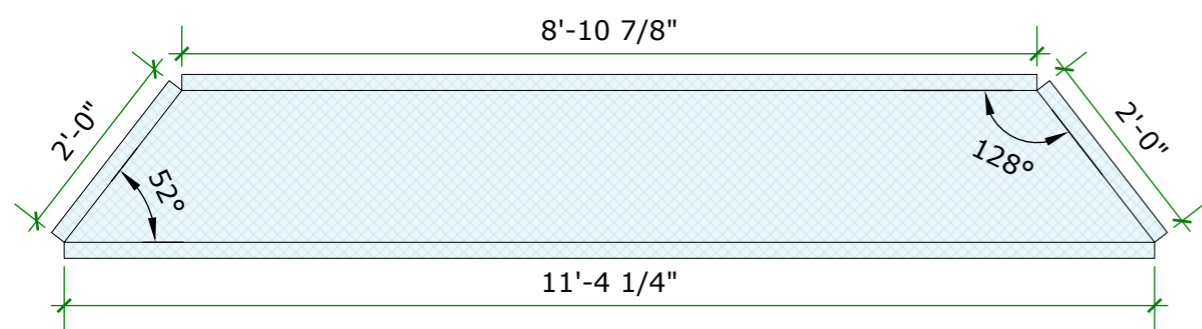

Bottom x4

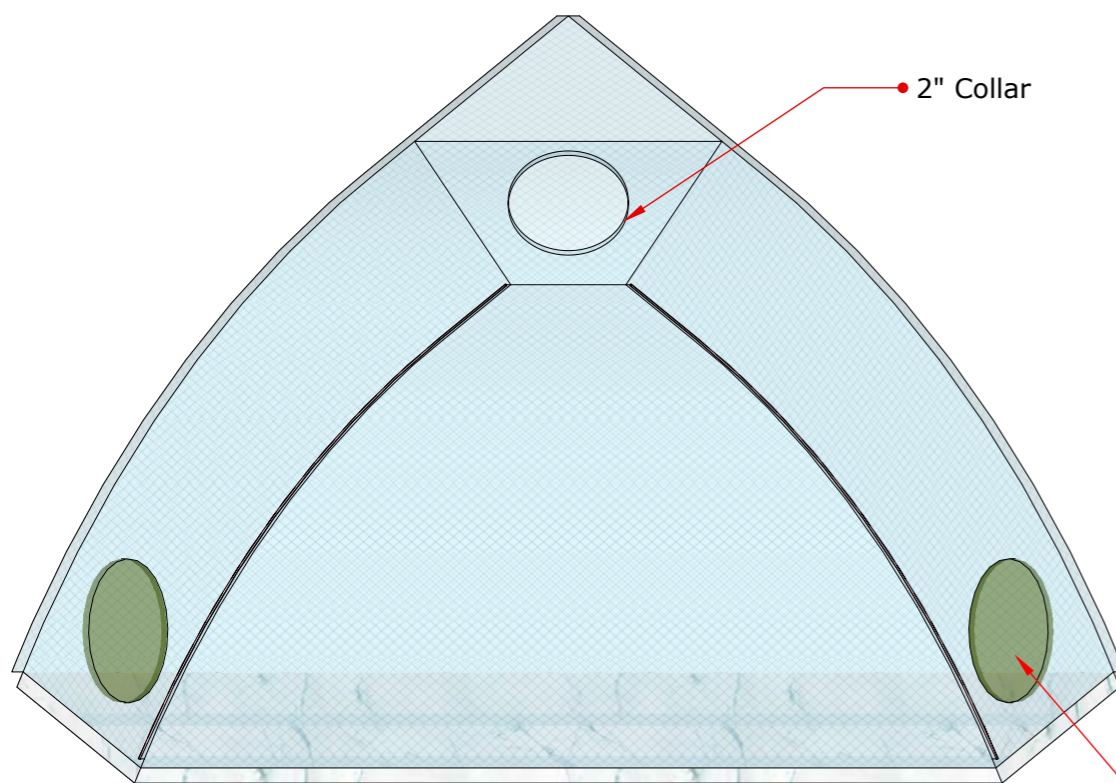
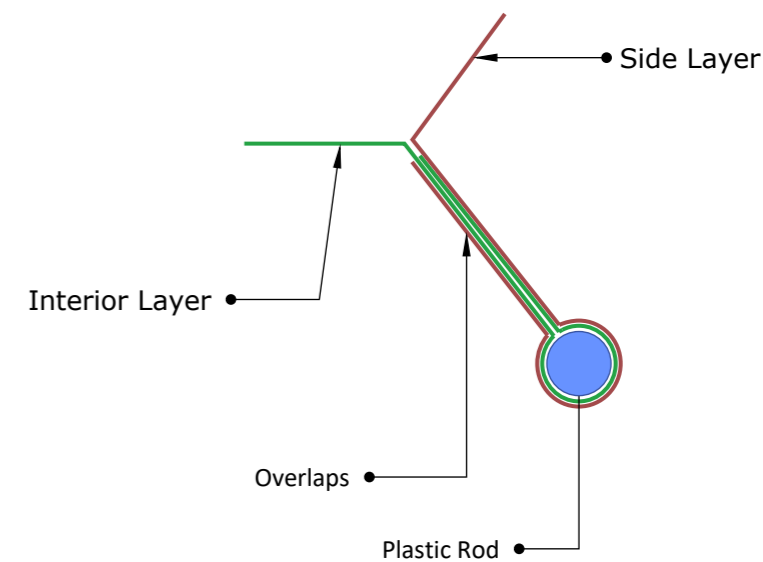

Insulation Board 1"

FAN PANEL X2

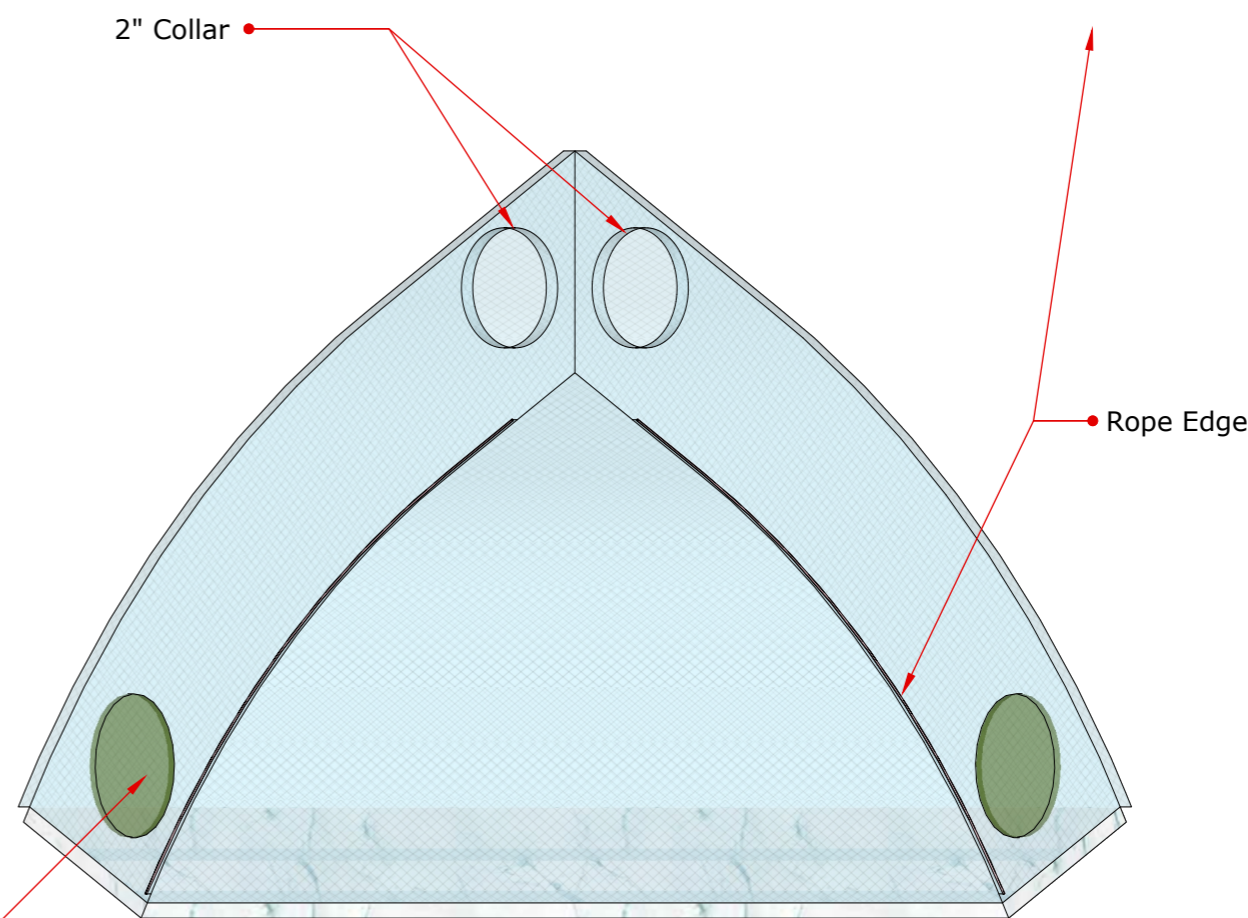

2" Collar

Rope Edge

Bubble Channel

SCREEN PANEL X2

Note: Each piece of material has an extended allowance (2") on each side for stitching/sewing between each piece.

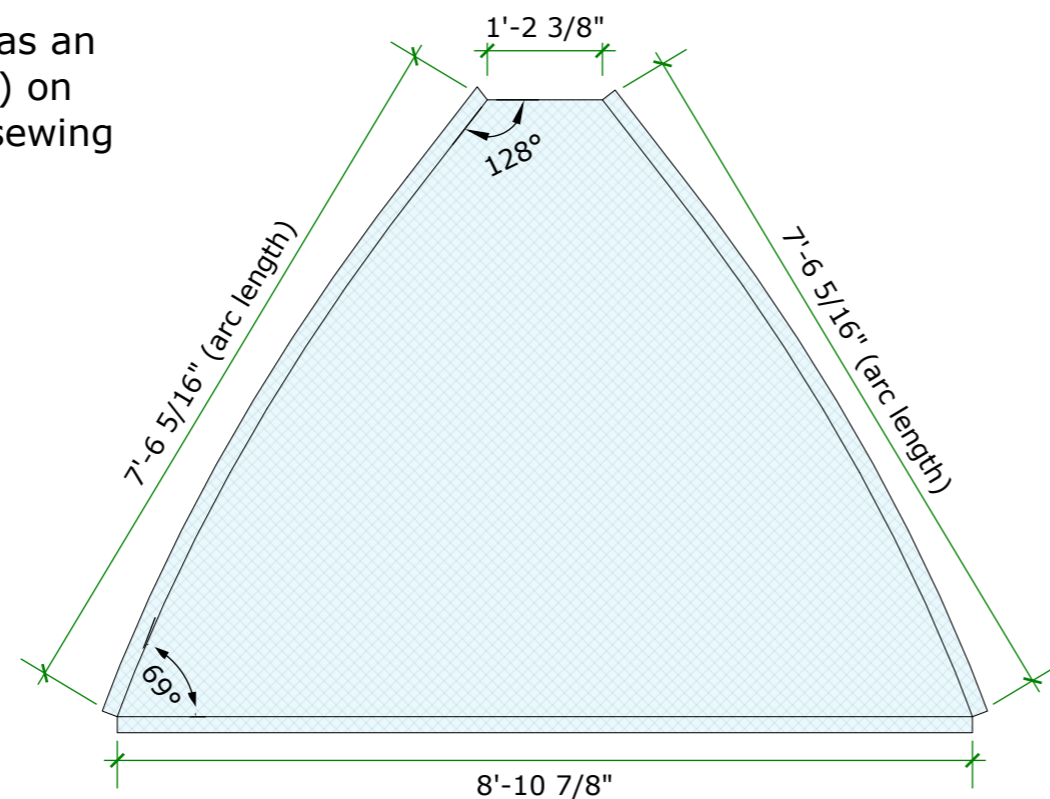

Interior(Fan Panel) x2

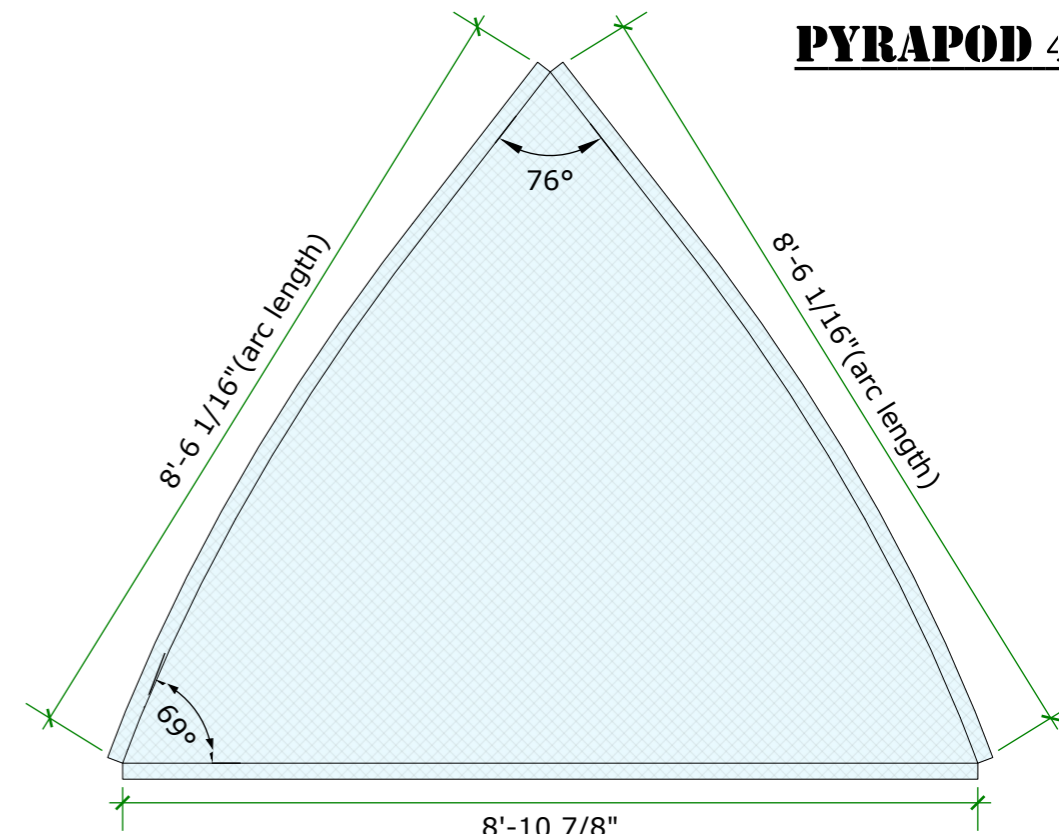

Interior (Screen Panel) x2

The structure of the channel is similar to that of the bubble machine, requiring secondary design

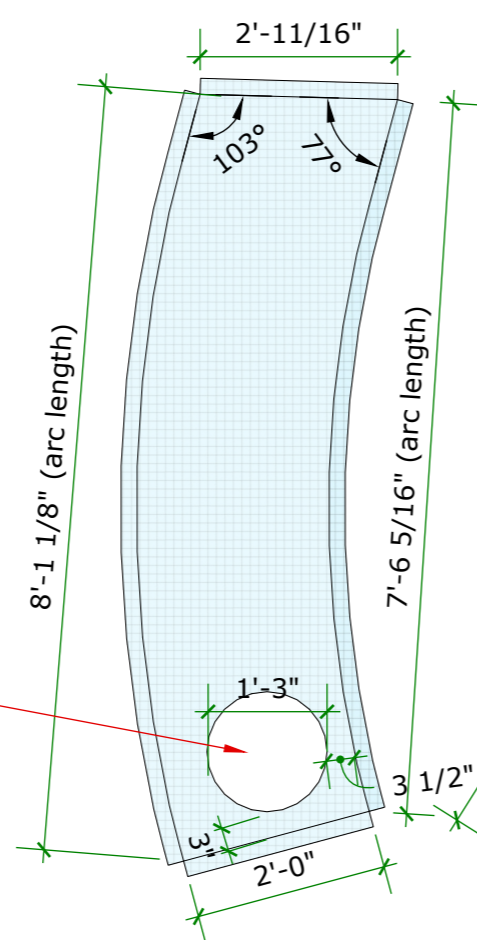

Side x4
(Fan Panel)

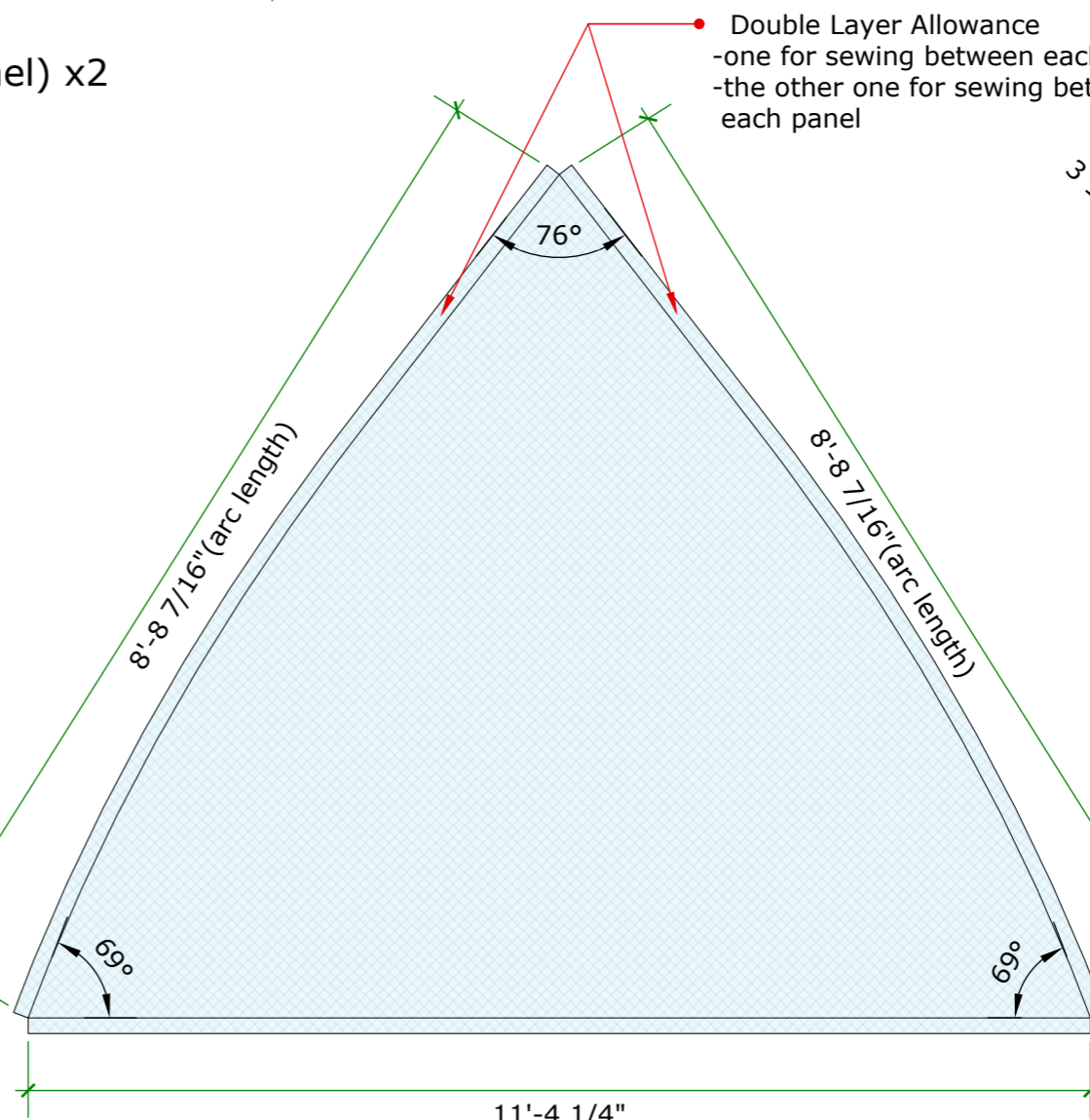

Exterior x4

Double Layer Allowance
-one for sewing between each piece
-the other one for sewing between each panel

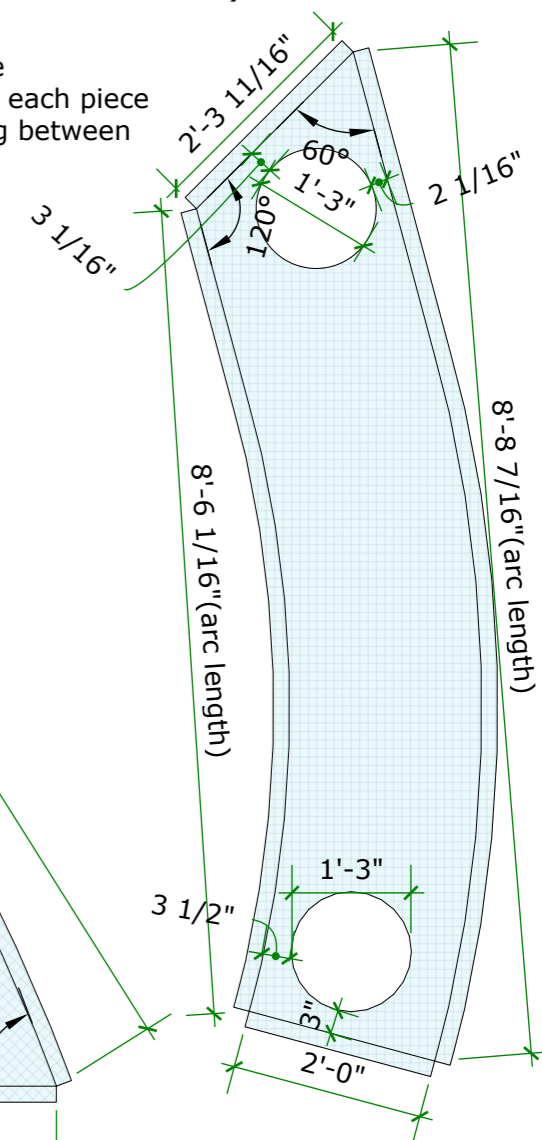

Side x4
(Screen Panel)

Roof Panel Exploded View (x4)
The sides are arcs, not straight lines

PYRAPOD 4T-2

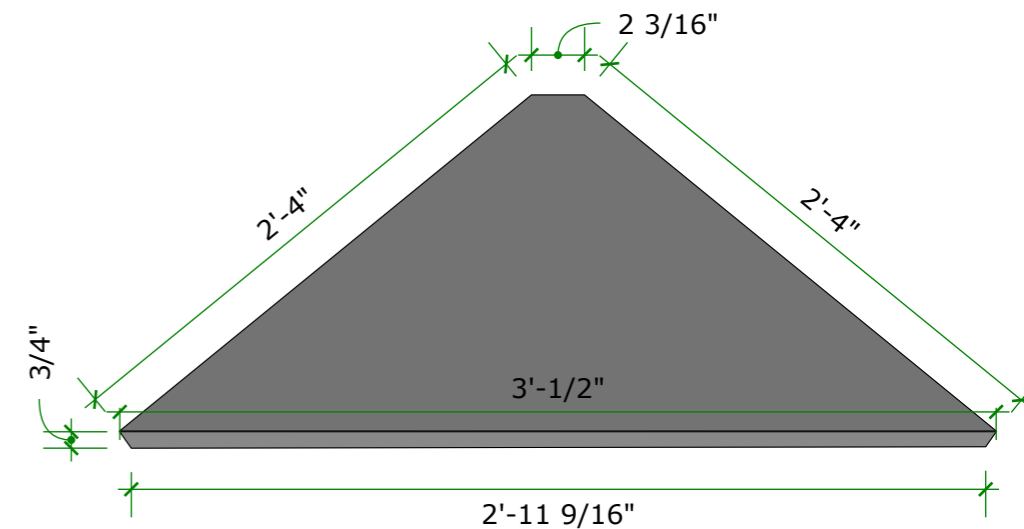
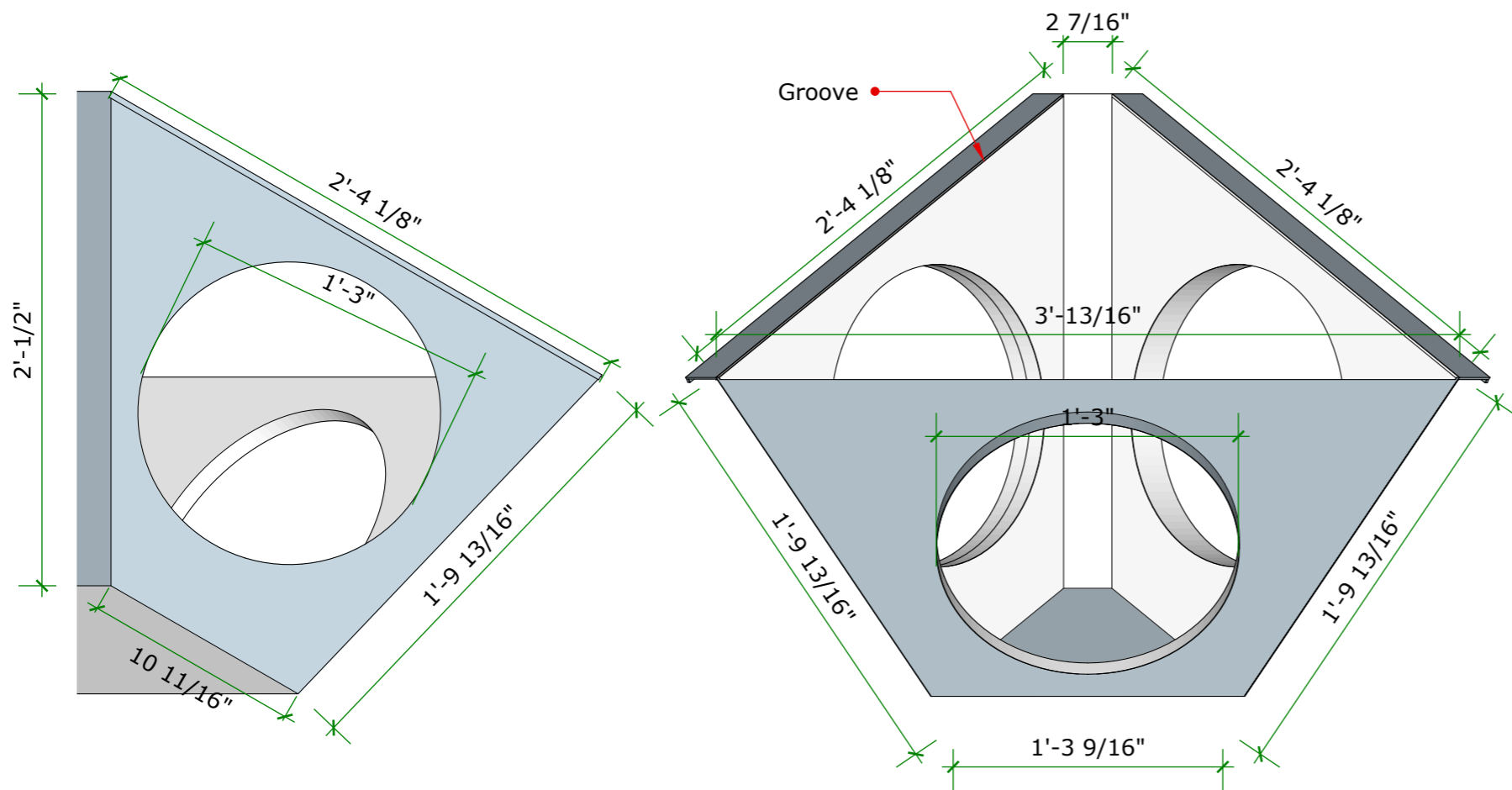

Sliding Top Cover

Bubble Mechine Elevation

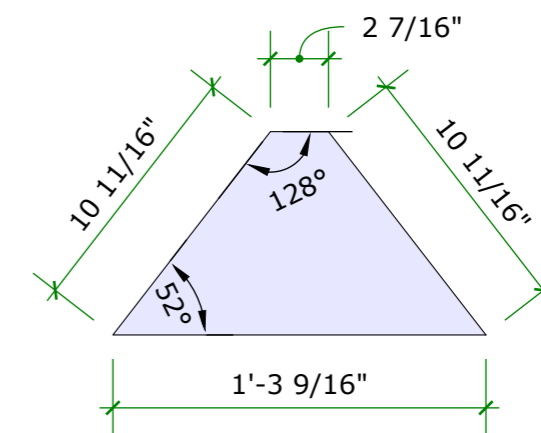

Bottom Piece

Bubble Mechine Exploded View
Each round hole has a 2" collar

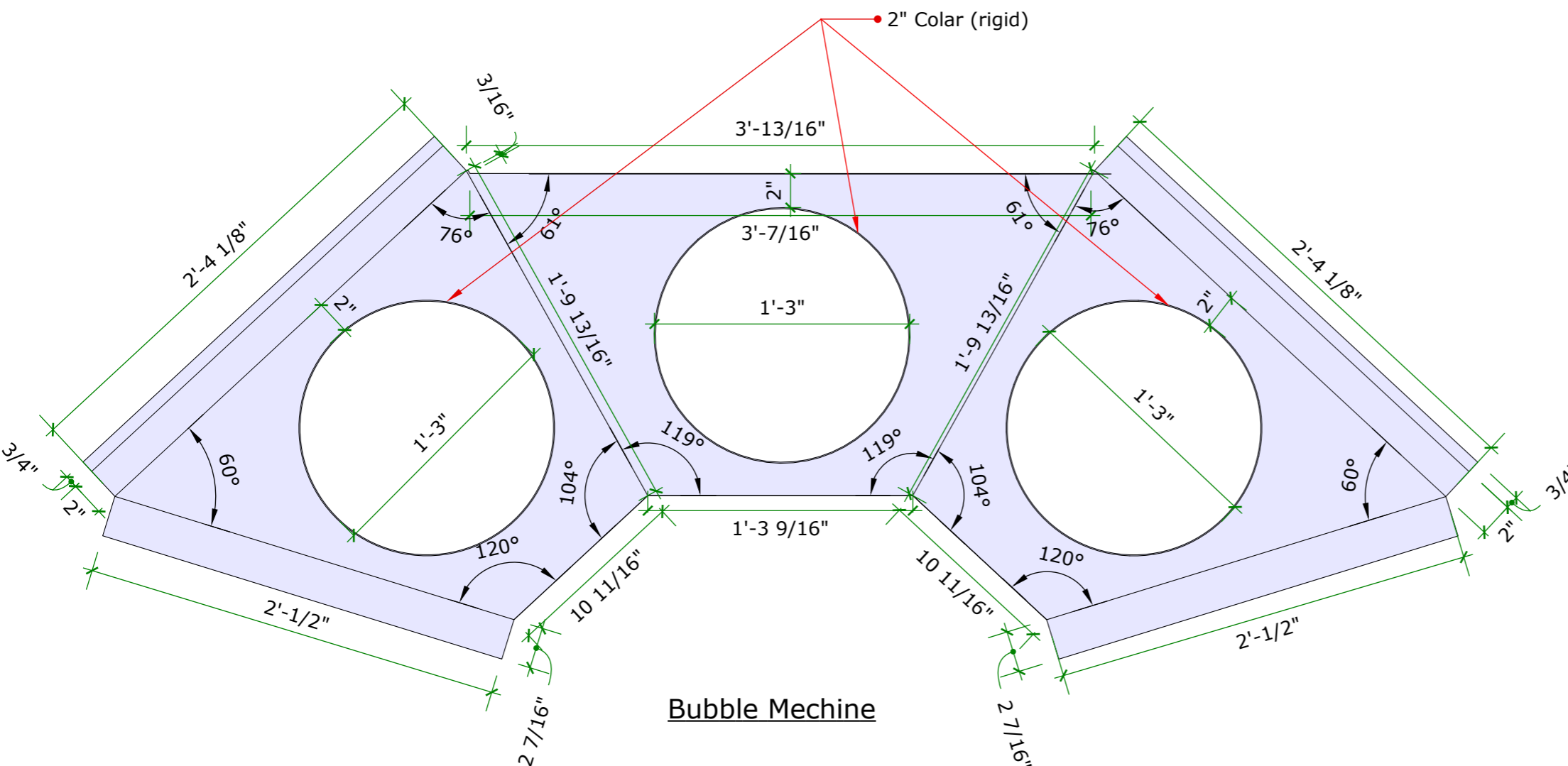

Bubble Mechine